

# PA(LOCK) Series

Sub-Miniature Pushbutton Switches



## SPECIFICATION:

### MAX. CURRENT/VOLTAGE RATING WITH RESISTIVE LOAD:

100mA 24VDC-life expectancy 200,000 cycles  
2A 125VAC-life expectancy 10,000 cycles

**INITIAL CONTACT RESISTANCE:** 50mΩ max.

**INSULATION RESISTANCE:** 1GΩ min.at 500VDC.

**DIELECTRIC STRENGTH:** 1,000 VAC rms.

**ELECTRICAL LIFE AT FULL LOAD:** 200,000 cycles.

**OPERATING TEMPERATURE:** -30°C to 85°C.

**PANEL THICKNESS:** 1.5 mm (.059) min. -4 mm (.157) max.

**TOTAL TRAVEL:** 2.5 mm (.098)

**OPERATING FORCE:** 2N-5N

**CONTACT BOUNCE:** 10 ms.

**MECHANICAL LIFE:** 1,000,000 cycles.

**TORQUE:** 0.5 Nm max.applied to nut

**SOLDERING:** 350°C max.for 5 seconds.

IP 67  
UL94V-0  
EN 60529  
IEC 60529

RoHS  
compliance

Pb  
RoHS



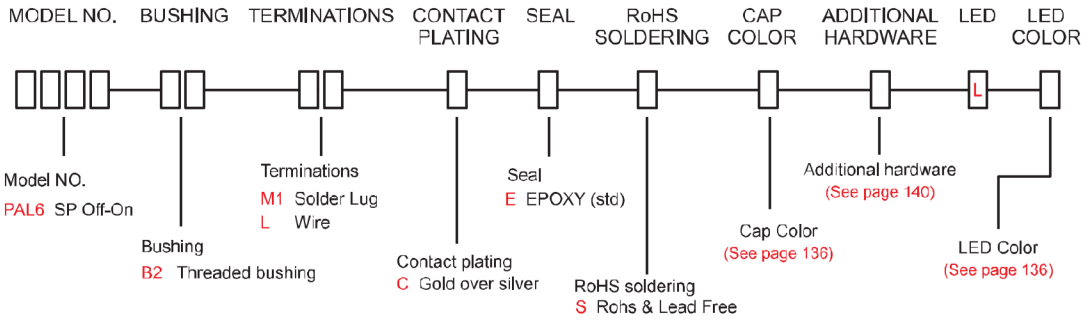

PA(LOCK)  
Pushbutton Switches

## HOW TO ORDER



## SWITCH FUNCTION

MODEL NO.	POS.1	POS.2
	 OFF	 ON
TERM. COMM.	OPEN	1-3
SCHMATIC		

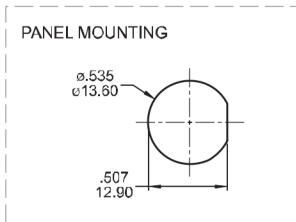
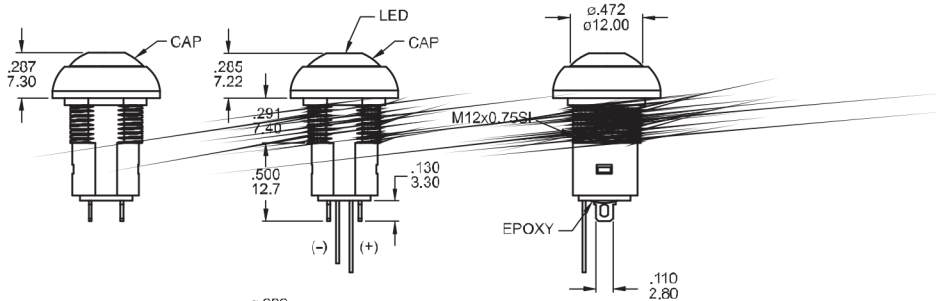

Non-LED

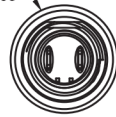

LED

### ADDITIONAL HARDWARE

- 1.M12 X 0.75 NUTS (MNU- PA03)
- 2.LOCKING WASHER (MNU-1M09)
- 3.O-RING (FCP-A253)

### Wire

※ Multi-wire lead AWG20,section 0.6mm²,UL approved,(Black / Green / Red)

### L=Wire length

Code:L1=500mm

Code:L2=90mm

Code:L3=100mm

